

# AWST S-Type Load Cells



AWST Load cell



AWST Load cell with accessories (Optional)

## Specifications

Capacity	tons	1.2, 2, 3 & 5t
Rated Output (RO)	mV/V	2 ± 0.01
Zero Balance	mV/V	±1%
Non-Linearity	(%RO)	0.025
Hysteresis	(%RO)	< 0.010%
Repeatability	(%RO)	< 0.015%
Creep	(%RO/30min)	< 0.023%
Temp effect on output	%RO/10°C	< 0.015
Temp effect on zero	%RO/10°C	< 0.020%
Input Impedance	(Ω)	400 +/- 30 Ω
Output Impedance	(Ω)	350 +/- 5 Ω
Insulation	(MΩ)	> 5000
Recommended Excitation	(V DC)	5-12
Maximum Excitation	(V DC)	18
Compensated Temp Range	(°C)	-10~+50
Operating Temp Range	(°C)	-20~+60
Safe Overload	(%RO)	150
Ultimate Overload	(%RO)	200
Cable Size	mm	∅5 x 5000 (5m)
Material		Tool Steel
Protection Class		IP67

## Dimensions (mm)

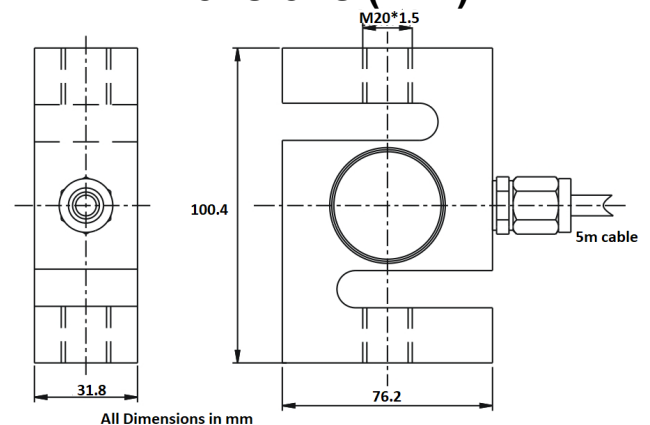

## Wiring Code

Excitation +ve Red  
 Excitation -ve Black  
 Signal +ve Green  
 Signal -ve White

Cable : 5mm dia, 5m long