

X-S02

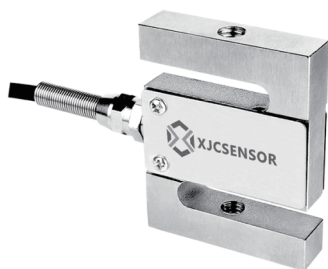

Feature

- ★ Adopts high-precision resistance strain principle
- ★ Supports force measurement in the range of 0-20ton.
- ★ S structural design, compression and tension, easy to install and flexible.
- ★ Stainless steel / Alloy steel material

Dimension and capacity can be customized by request.

Technical specifications

Capacity (Optional)	5kg,10kg,20kg,50kg,100kg,200kg,500kg,1t,1.5t,2t,5t,7t,8t,10t,20t		
Nonlinearity	0.02~0.1% F.S.	Rated output	2.0 ± 0.2 mV/V
Recommended excitation	5-10VDC	Maximum excitation	10V DC
Protection class	IP66	Compensated temp range	- 10 ~ 40 °C
Hysteresis	0.02~0.05% F.S.	Operating temp range	- 20 ~ 80 °C
Repeatability	0.02~0.05% F.S.	Insulation	≥ 5000MΩ / 100VDC
Input impedance	380 ± 30Ω	Output impedance	350 ± 5Ω
Creep (30min)	≤ 0.02% F.S.	Temp effect on output	≤ 0.02% F.S. / 10°C
Zero balance	± 1% F.S.	Temp effect on zero	≤ 0.02% F.S. / 10°C
Safe load limit	150%F.S.	Ultimate load limit	200%F.S.
Cable size	Ø5 x3m	Fatigue life	Full scale more than 1 million times
Cable connection	Ex + : Red; Ex - : Black; Sig + : Green; Sig - : White		

Load direction

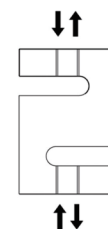

Wiring code

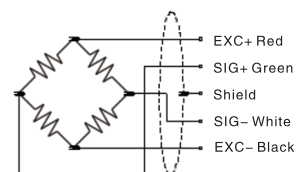

Dimensional Drawings (mm)

Capacity	A	B	C	D
5/10/20/50kg	M8	12.7	51	64
100/200/500kg	M12	19.1	51	76
1/1.5t	M12	25.4	51	76
2/5t	M20	25.4	76	108
7/8/10t	M30	51	127	178
20t	M36 x 3	60	140	188

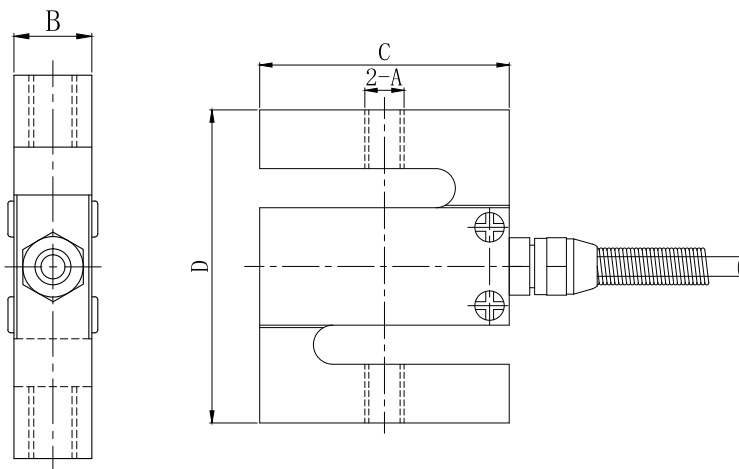

Applications

Mainly applied in tension and compression testing instruments and automatic equipments fields, such as small range of force testing instruments, hopper scales, insertion force test instruments, riveting machine, welding machine, hot & cold lamination machine, feeling tester for keyboard switch, and etc.